

RN-100-2,3,4/300R-2,3,4 | RWM-160R-2,3,4/200R-2,3,4/RBM-160

MULTI-FACE PLATE, MULTI-SPINDLE TABLE • PNEUMATIC CLAMPING

These high speed, multi-spindle rotary tables are particularly suited for multi-spindle vertical machining centers. The compact, multi-spindle RN-100 is ideal for use on drilling and tapping machines.



RN-100R-4

Table Model		RN-100-2,3,4	RWM-160R-2,3,4	RWM-200R-2,3,4	RN-300R-2,3,4	RBM-160-2,3,4	
Versions available		R, L	R,L	R,L	R	R/L	
Spindle outer diameter	mm	80h7	100h7	120h7	-	100h7	
Table diameter (optional)	mm	(115)	(160)	(200)	320	(160)	
Center height	mm	135	135	160	210	135	
Center bore	Nose Diameter	mm	50H7	55H7	65H7	110H7	55H7
	Thru Diameter	mm	30	40	45	85	40
Table T-slot width (with face plate)		(10H8)	(12H8)	(12H8)	14H8	(12H8)	
Minimum spindle center distance		120	215	250	380	215	
Guide block width		18h7	14h7	18h7	18h7	14H7	
Servo motor (Fanuc)*		Alpha 4i	160R-2 uses Alpha 4i 160R-3,4 use Alpha 8i	Alpha 8i	Alpha 12i	Alpha 4i	
Maximum motor speed	rpm	5,000	5,000	4,000	4,000	5,000	
Speed reduction ratio		1/36	1/72	1/72	1/120	1/72	
Number of spindles		2 3 4	2	2	2 3	2	
Maximum table speed	rpm	138.9	69.4	55	33.3	69.4	
Inertia converted into motor shaft	$\times 10^{-3}\text{kg}\cdot\text{m}^2$.64 .92 1.06	.31	.55	2.09 2.63	.31	
Clamp system		Pneumatic					
Clamp torque @72psi	Nm (ft. lbs.)	80 (59)	500 (368)	800 (590)	880 (649)	500 (368)	
Indexing accuracy	arc sec.	±30	±12.5	±10	±15	±12.5	
Net Weight [dual spindle]	kg (lbs.)	70-110 (154-242)	[105 (231)]	[155 (341)]	[480 (1,056)]	[105 (231)]	
Allowable wheel torque	Nm (ft. lbs.)	178 (131)	206 (151)	288 (212)	764 (563)	206 (151)	
Allowable work inertia	$\text{kg}\cdot\text{m}^2$.10	.64	1.25	3.7	.64	
Allowable work weight	kg (lbs) [w/ tailstock]	25 (55) [50 (110)]	100 (220) [175 (385)]	125 (275) [250 (550)]	150 (330) [350 (770)]	100 (220)	
	kg (lbs)	50 (110)	-	-	350 (770)	-	
Allowable load when table clamped	N (lbf)	5,880 (1,317)	10,800 (2,418)	14,400 (3,211)	19,600 (4,390)	10,800 (2,418)	
	Nm (ft. lbs.)	80 (59)	500 (368)	800 (590)	880 (649)	500 (368)	
	Nm (ft. lbs.)	156 (115)	780 (574)	1,900 (1,400)	1,960 (1,444)	780 (574)	

* Other motors & RPM available
Specifications subject to change without notice

Dimensions

Drawings

RN-100R-2,3,4

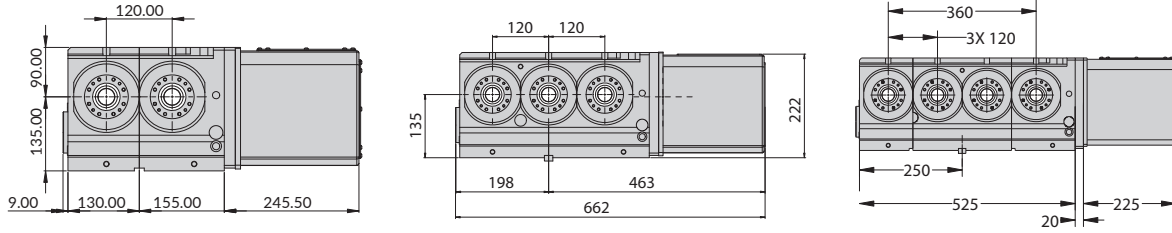

RWM-160R-2,3,4 (3 spindle model also available)

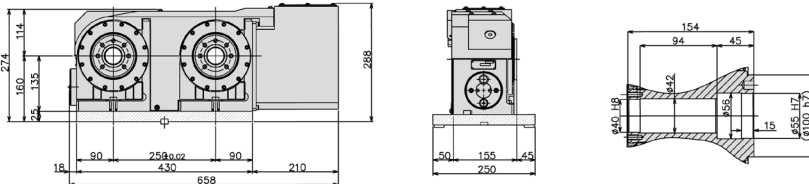

*Baseplate not included

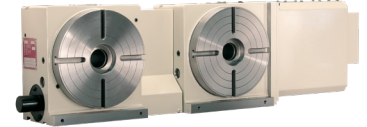

RN-250-2

RWM-200R-2,3,4 (3 spindle model also available)

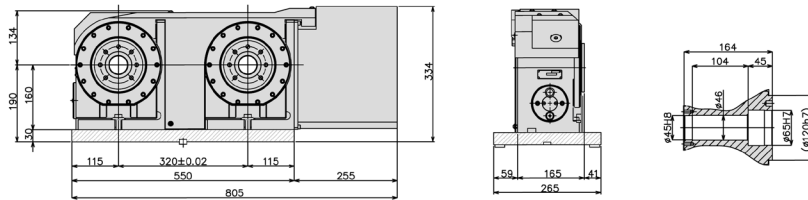

*Baseplate not included



RN-300R-2,3,4 (3 spindle model also available)

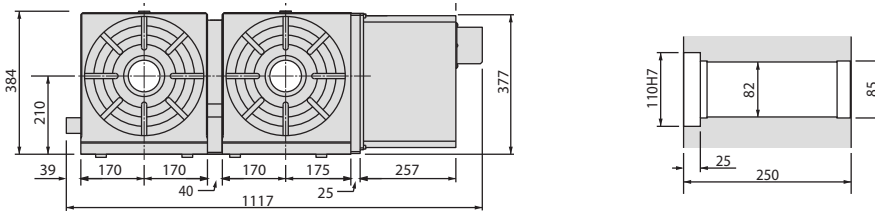

RBM-160

RBM-160

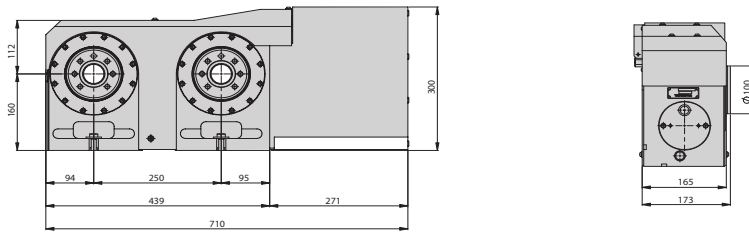

Options & Accessories

TPC NC Controller	p.62
Chucks	p.74
Tailstock	p.75
Support Spindle	p.77
Face Plate	p.77
Encoder / Scale	p.78
Pull Stud Device	p.79
Rotary Joint	p.79
Booster	p.80
PVC or Steel Cables	p.81

The dimensions above are for tables with a FANUC servo motor. Other motors available (dimensions may increase).

*Minimum center distance displayed above other center distances available

Clamping Block and Bolt

Dimensions = mm

Type	Q'ty	T-Slot Width	A	B	C	D	E	F	G	H	I	J	K	L	M	
RN-100R	I	2	18	25	12	80	12	33	35	22	21	11	65	40	28	16
RWM-160R	-	-	-	-	-	-	-	-	-	-	-	-	-	-	-	-
RWM-200R	-	-	-	-	-	-	-	-	-	-	-	-	-	-	-	-
RN-300R	I	4	18	30	15	90	16	31	43	25	21	11	70	46	28	16

Type I

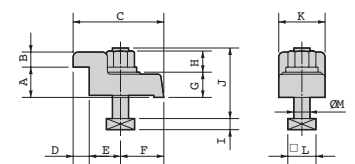

Note: When using a machine with a T-slot other than the above, use suitable clamping blocks and bolts that are available on the market, or order custom-made ones from KOMA (opt.)